

**B.SC. (HONS) CONSTRUCTION PROJECT  
MANAGEMENT & APPLIED TECHNOLOGY**

**B.SC. ADVANCED WOOD & SUSTAINABLE  
BUILDING TECHNOLOGY**

**HIGHER CERTIFICATE APPLIED  
CONSTRUCTION TECHNOLOGY**



**UNIQUE  
ACADEMIC  
EXPERIENCE**

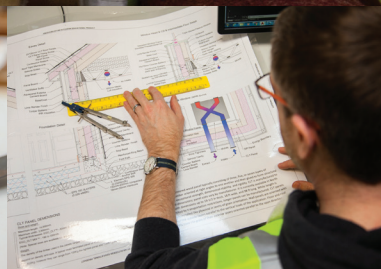

**IT Sligo**  
An Institiúid Teicneolaíochta, Sígeach

# HIGHER CERTIFICATE OF SCIENCE

## APPLIED CONSTRUCTION TECHNOLOGY

**Award:**  
Higher  
Certificate  
(Level 6)

**CAO Code:**  
SG308

**CAO Points:**  
171

**Duration:**  
2 Years

**Number of  
Places:**  
32

www.itsligo.ie/SG308

### What is Applied Construction Technology?

Will equip graduates with the skills and technical knowledge required to enter the construction industry at technician level. Students will gain a thorough grounding in the key concepts and practical skills required in the sector.

### Programme Description

This new two year level 6 Higher Certificate in Applied Construction Technology is based around IT Sligo's state of the art construction workshops, delivering a unique experience to students by applying theoretical knowledge to practical projects.

Students will gain a thorough grounding in the key concepts and practical skills required in the construction sector as well as practical skills in carpentry and joinery. Students will also gain an understanding of how emerging technologies such as NZEB (Nearly Zero Energy Building standards), BIM (Building Information Modelling) affect the design and production phases of construction projects.

Students explore scientific principles and the behaviour of materials used in construction, understand current health and safety regulations and methods of quantifying materials for the construction of domestic buildings. Students will acquire a range of employability skills through team project work and ongoing development of transferable skills e.g. report writing, communication and time management, important components of career development.

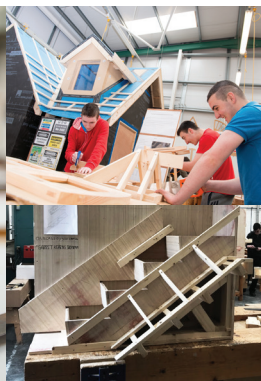

BACHELOR OF SCIENCE

## ADVANCED WOOD & SUSTAINABLE BUILDING TECHNOLOGY

### What is Advanced Wood and Sustainable Building Technology?

This is designed to teach students how practical carpentry and construction skills are changing toward low carbon and low energy designs.

### Programme Description

The focus of the programme is to create a strong foundation in carpentry and joinery practice and develop skills in sustainable building technologies, methods and materials, including the construction of low-energy buildings and the retrofitting and refurbishment of existing dwellings to achieve a low carbon design.

IT Sligo ensure they stay ahead of the latest advancements in construction by regular contact with industry experts. Students will use the latest computer software to bring a project from the design phase through to completion. Building Information Modelling (BIM) and virtual reality is used to design and view a project Planning software is used to quantifying and programme the work. While CNC technology can then be used to construct the project in our purpose built, highly equipped workshops.

### Special Features:

This programme has work placement in year 3 and has professional accreditation from the Chartered Institute of Building (CIOB).

**Award:**  
Ordinary  
Degree  
(Level 7)

**CAO Code:**  
SG332

**CAO Points:**  
208

**Duration:**  
3 Years

**Number of  
Places:**  
32

**Work  
Placement:**  
Yes

**Professional  
Accreditation:**  
Yes



**BACHELOR OF SCIENCE (HONOURS)**

# **CONSTRUCTION PROJECT MANAGEMENT AND APPLIED TECHNOLOGY**

## **What is Construction Project Management?**

Construction Project Management is a professional field that focuses on each part of the construction process, from cost, scope and timelines, of any built environment.

## **Programme Description**

This programme will blend traditional practical skills including carpentry and joinery, with modern construction approaches, such as Building Information Modelling (BIM) and Lean Construction. Coupled with key modules for construction management, graduates gain the competencies to manage large complex construction projects and are highly sought after. Graduates will develop an appreciation for design/planning on small scale workshop projects right up to Virtual Modelled buildings where collaboration is essential through digital technologies. You will learn how to plan, organise and control construction operations and you will gain knowledge in all stages of the process – from initial feasibility studies through to design, construction, maintenance, refurbishment and demolition.

## **Special Features:**

This programme has work placement in year 3 and has professional accreditation from SCSl to become a Chartered Project Management Surveyor and also have been designed to meet the Teaching Council's entry requirements for Design and Communication Graphics (DCG) and Construction Studies for the Leaving Certificate.

**Award:**  
Honours  
Degree  
(Level 8)

**CAO Code:**  
SG346

**CAO Points:**  
291

**Duration:**  
4 Years

**Number of  
Places:**  
32

**Work  
Placement:**  
Yes

**Professional  
Accreditation:**  
Yes

[www.itsligo.ie/SG346](http://www.itsligo.ie/SG346)

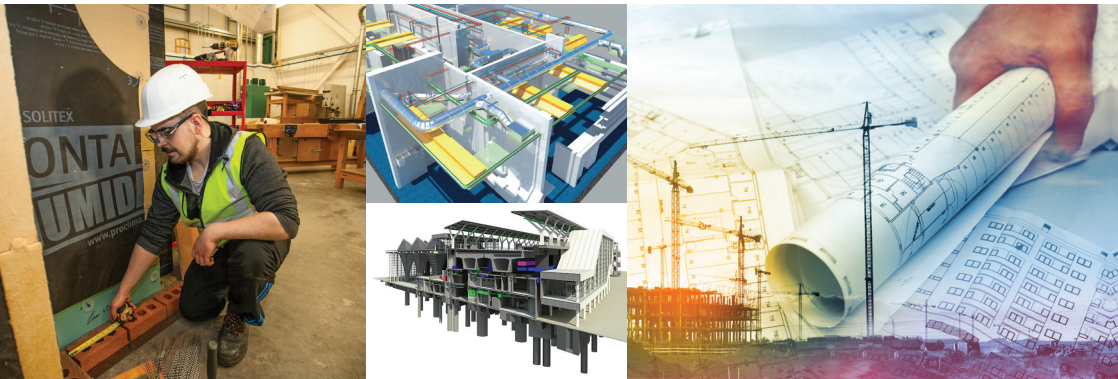

# PROGRESSION OPPORTUNITIES

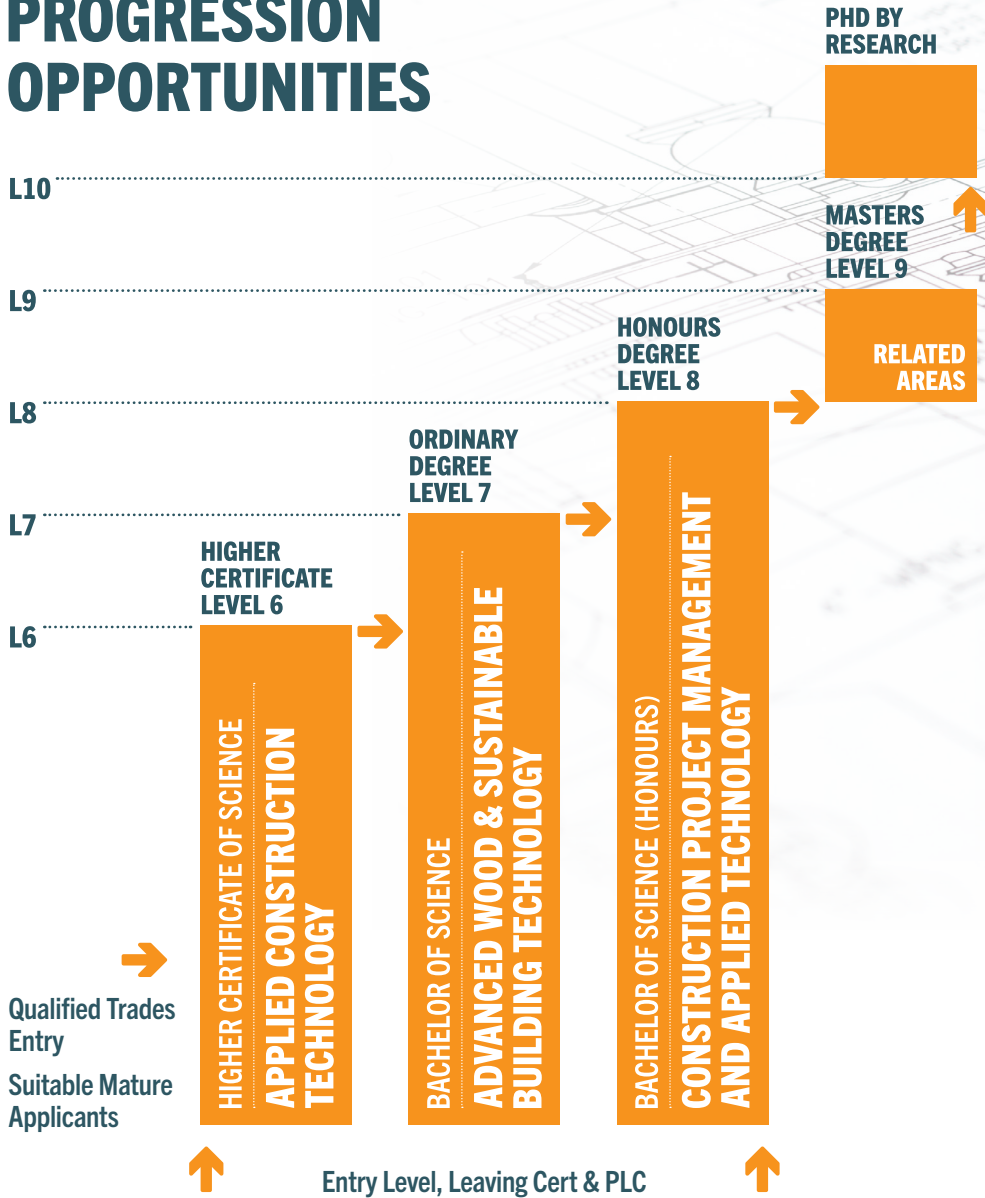

## GRADUATE DESTINATIONS:

Many graduates work as Building Contractors, Construction Project Managers, Carpenters, Site Managers and Architectural Technicians.

A wide and diverse range of employment opportunities are on offer from construction planning to building surveying and site mapping.

## CONTACT EMAIL ADDRESS

[gallagher.kieran@itsligo.ie](mailto:gallagher.kieran@itsligo.ie)

[mullaney.paul@itsligo.ie](mailto:mullaney.paul@itsligo.ie)

## INSTITUTE OF TECHNOLOGY, SLIGO

ASH LANE, SLIGO, F91 YW50, IRELAND

**T:** 00353 (0)71 93 05222

**F:** 00353 (0)71 91 60475

**E:** [INFO@ITSLIGO.IE](mailto:INFO@ITSLIGO.IE)

**W:** [ITSLIGO.IE](http://ITSLIGO.IE)

